

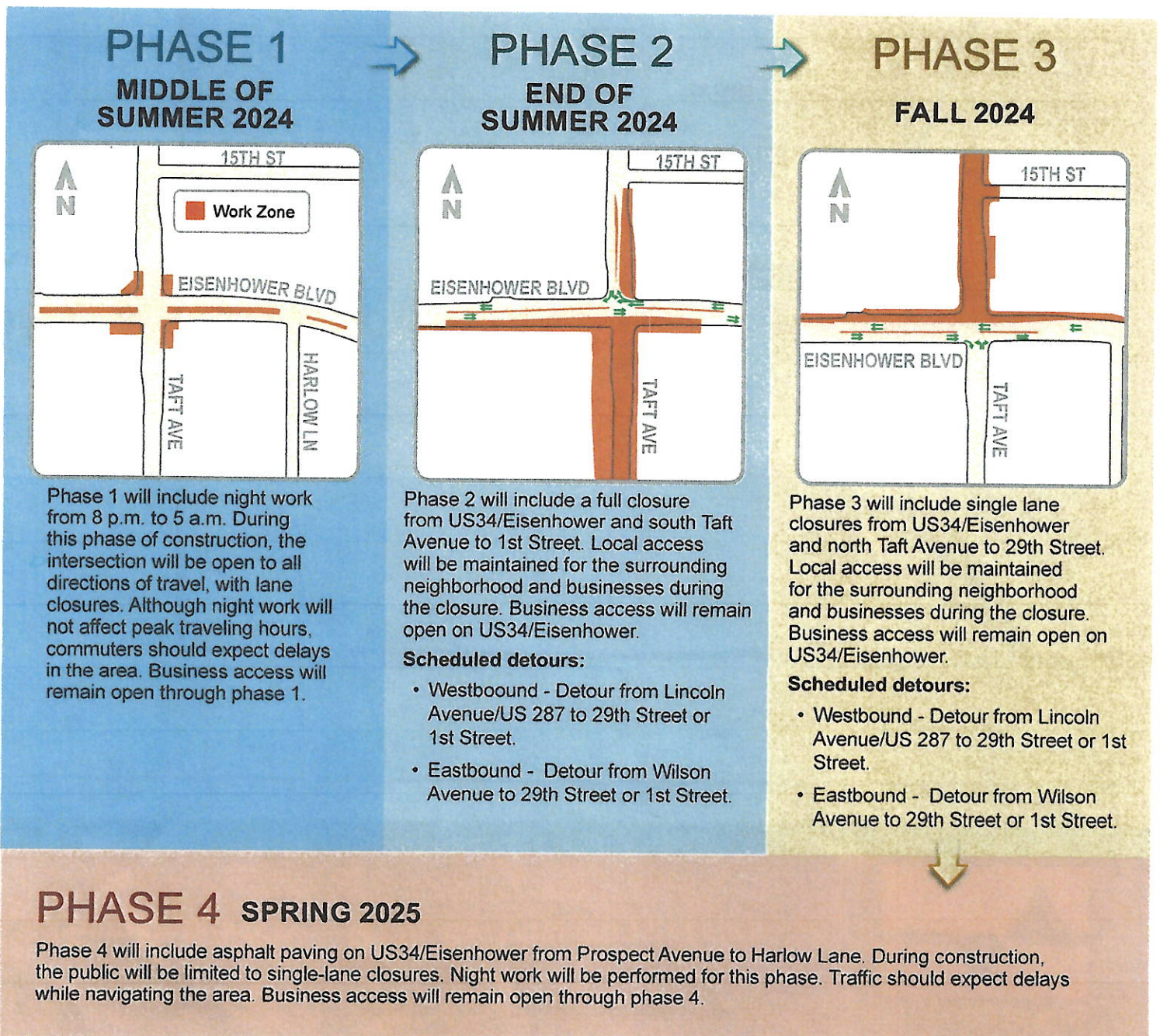

US 34 and Taft Avenue Intersection Improvement Project

The US 34 and Taft Avenue Intersection Improvement Project is anticipated to begin this summer. This project addresses intersection improvements to aging waterline and stormwater infrastructure, improving bike and pedestrian accesses, reducing congestion and strengthening safety at one of Loveland's busiest areas.

US34/Eisenhower Boulevard plays a pivotal role in our region's transportation network. It serves not only as a main corridor for Lovelanders but as the gateway to Rocky Mountain National Park, attracting a significant number of visitors.





US 34 and Taft Avenue Intersection Improvement Project

PHASE 2: END OF SUMMER 2024

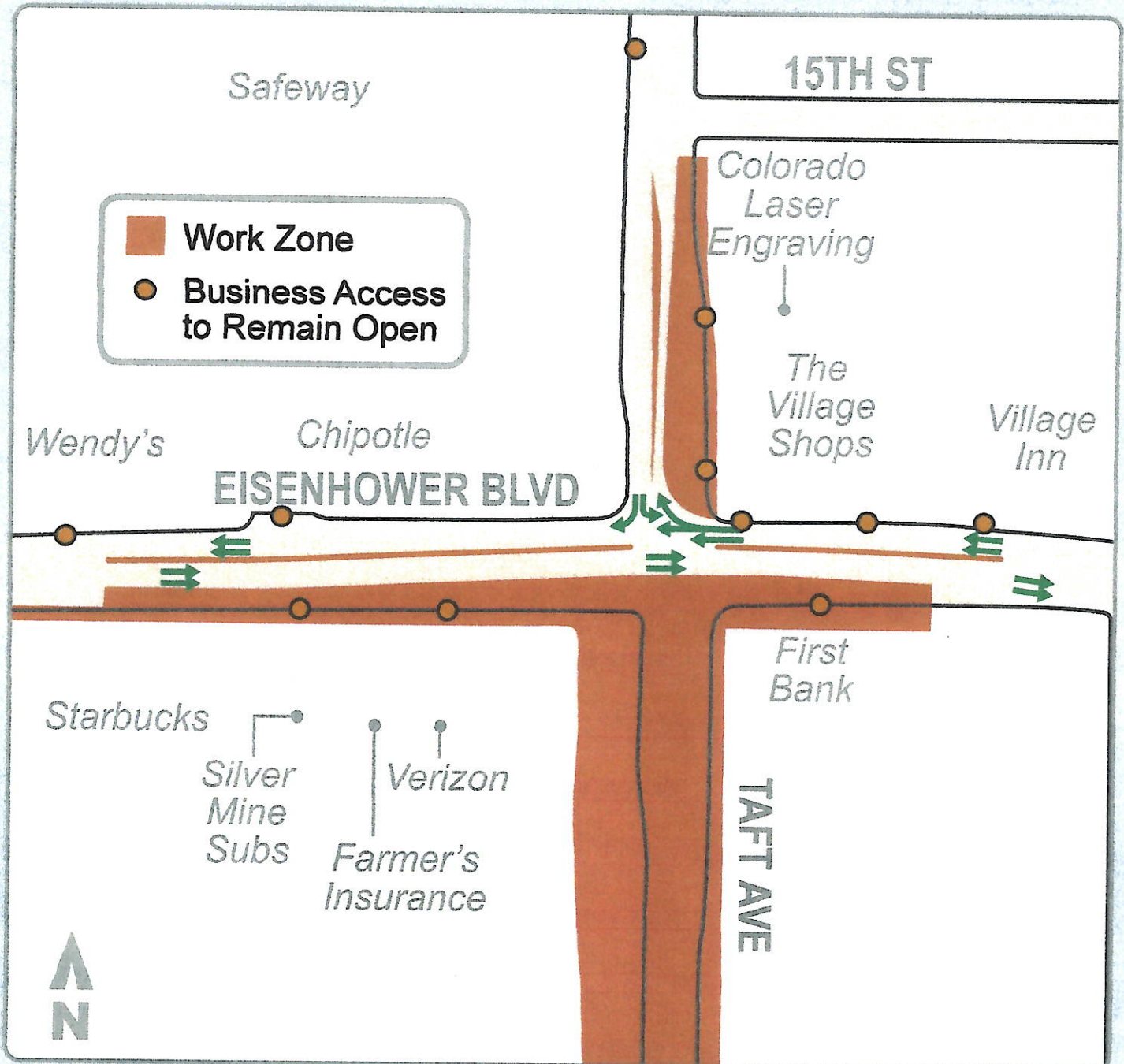

Phase 2 will include a full closure from US34/ Eisenhower and south Taft Avenue to 1st Street. Local access will be maintained for the surrounding neighborhood and businesses during the closure. Business access will remain open on US34/Eisenhower.

Scheduled detours:

- Westbound - Detour from Lincoln Avenue/US 287 to 29th Street or 1st Street.
- Eastbound - Detour from Wilson Avenue to 29th Street or 1st Street.

FUNDING FOR THE PROJECT

The US 34 and Taft Avenue Intersection Improvement Project has been a City priority for a number of years due to the need for improvements related to safety, congestion, and bike and pedestrian access. In collaboration with the Public Works Transportation Engineering, Stormwater, and Loveland Water and Power, project will soon be complete. Funding for the project includes federal grants, TABOR excess, Capital Expansion Fees, and General Funds.

PROJECT DETOUR MAP



To learn more about the project, visit:
LetsTalkLoveland.org/Taft-And-US34-Widening.

970-962-2524



PublicWorksInfo@cityofloveland.org